



HOSHIZAKI

IM - 240PE - 23 - F

Model Number
91000188

Cube 145kg Ice Maker with Drain Pump - Self Contained



Hoshizaki IM-240PE-F-23 FlexiCube model is a self-contained ice maker with internal drain pump producing up to 165kg (10°C Air temp; 10°C Water) of cube ice per 24 hours.

- Produces compact, dry, tasteless and slow melting cube ice, allowing just the right amount of dilution.
- Automated cleaning (wash auto-restart).
- Water circuit cleaning notification.
- Condenser cleaning notification.
- Magnetic dc pump motor with variable speed.
- High grade stainless steel.
- Stand-by/wash buttons.
- Removable door gasket.
- Easy-clean air filter.
- Flexicube models include an integrated drain pump, enabling flexible placement of the ice maker, regardless of drain position or height.
- Internal drain pump models allow for positioning radius of 10m distance and up to 1.5m height to drain point (based at max 10m distance).

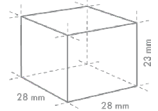

Cube Size: **M-23**
Weight: 17 g

PRODUCT SPECIFICATION

| Ice Type | Cube |
|-----------------------------------|---|
| Production Capacity per 24hours | Approx. 165kg @10°C Air temp; 10°C Water Approx. 145kg @ 21°C Air temp; 15°C Water Approx. 140kg @ 32°C Air temp; 21°C Water |
| Max Storage Capacity | Approx. 110kg (Bin Control Setting Approx. 80kg) |
| Dimensions | 704mm (W), 665mm (D), 1580mm (H) |
| Weight Net Packed Weight | 102kg 115kg |
| Cooling | Air |
| AC Supply Voltage | 1 PHASE 220-240V 50Hz/ 10 AMP Plug |
| Refrigerant | R290 |
| Operating Conditions | Ambient Temp.: 1-40°C Water Supply Temp.: 5-35°C Water Supply Pressure: 0.07-0.8MPa (0.7 - 8bar) Voltage Range: Rated Voltage ±6% |
| Water Consumption Per 24h | Approx. 0.68m ³ @10°C Air temp; 10°C Water Approx. 0.37m ³ @ 21°C Air temp; 15°C Water Approx. 0.36m ³ @ 32°C Air temp; 21°C Water |
| Heat Rejection (AT 32°C, WT 21°C) | 2580W |
| Accessories included | Installation kit, Scoop |
| GEM Number | AIM0029 |

INSTALLATION REQUIREMENTS

- Ensure the condenser is cleaned periodically as per the manufacturer’s manual.
- Do not plug the unit into multi-plug power boards with other appliances
- Room ventilation or air conditioning can improve the situation by reducing the humidity.
- Hoshizaki recommends the use of a compatible water filter to prevent non-warrantable scale & sediment complications.

*Refer to manual for full installation & maintenance requirements.



For free 6 month extended warranty, register online within 4 weeks of purchase date.
hoshizaki.com.au



HOSHIZAKI

IM - 240PE - 23 - F

Cube 145kg Ice Maker with Drain Pump - Self Contained

TECHNICAL DRAWING

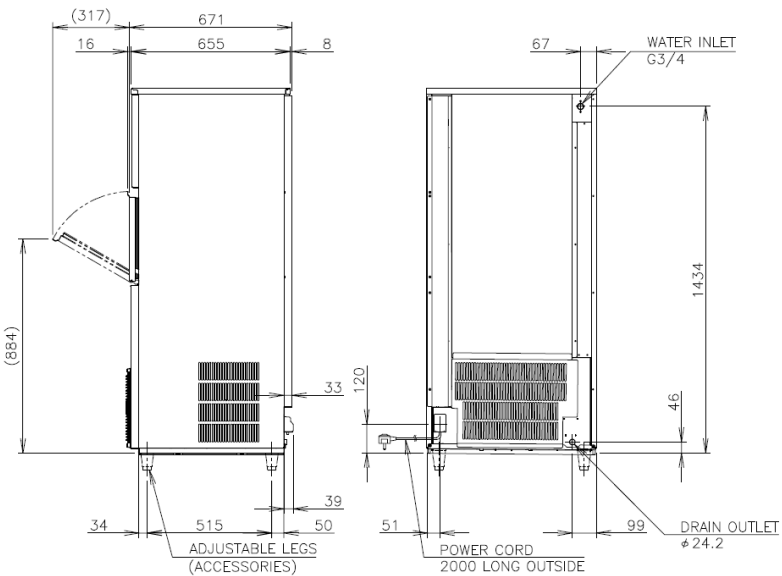
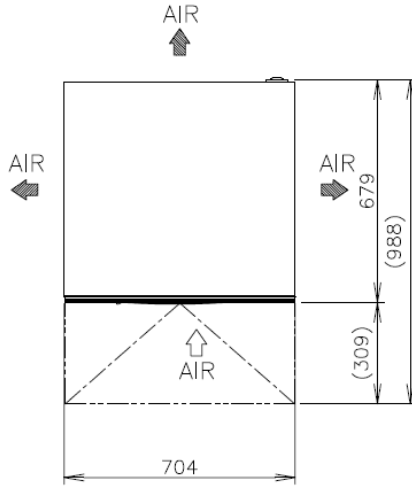
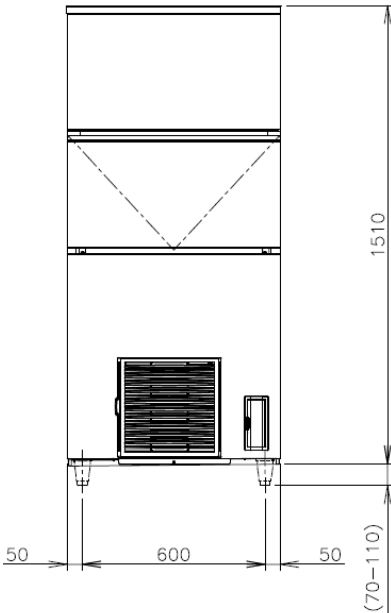

For free 6 month extended warranty, register online within 4 weeks of purchase date.

hoshizaki.com.au